

PLAN	DATE	BY
NOTED		
NOTE BOOK		
ALIGNED CHECKED		
RT. OF WAY CHECKED		
No.		

PROFILE	DATE	BY
NOTED		
NOTE BOOK		
BA'S NOTED		
STRUCTURE NOTATIONS CHECKED		
No.		

godsdendr
C:\15092\15092pf2.dgn
20-NOV-2002

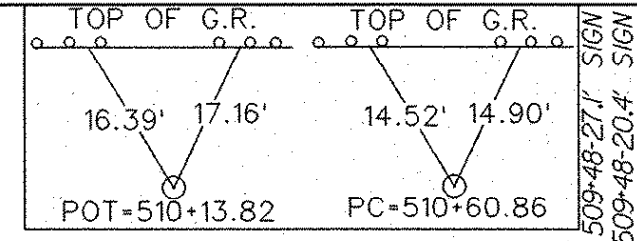
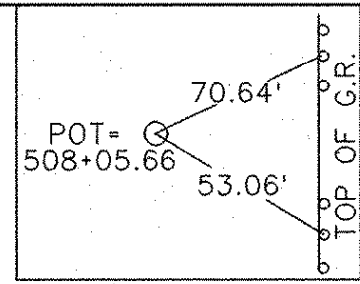

510+32.2' WINGWALL
510+27.6' WINGWALL
510+26.8' CULVERT
510+25.4' WINGWALL
510+24.8' FENCE

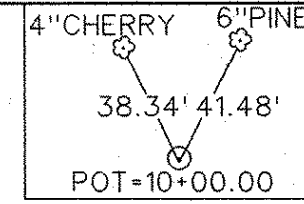
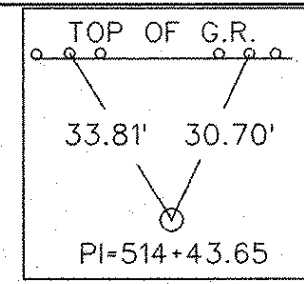

PIN No. 15092					
FED. ROAD	STATE	COUNTY	FILE NO.	ROUTE	SHEET
NO.	NO.	NO.	NO.	NO.	NO.
3	S.C.	LEXINGTON	32/23A	LINE 'C'	20

TIE EQUALITY:
P.O.T. 508+05.66 LINE 'C'
P.I. 40+15.84 RTE. 6

TIE EQUALITY:
P.O.T. 510+13.82 LINE 'C'
P.I. 15+00.00 OUTFALL T-RAV. *3
SEE SHEET No. 29

SURVEY STA. 508+50.02 BEGIN
FILE 32/23A
LINE 'C'

SURVEY STA. 515+00.00 END
FILE 32/23A
LINE 'C'

BM *4 NAIL IN BASE P.P. *214716
180' RT. STA. 44+02 RTE. 6 EL. 537.47

BM *4C NAIL IN BASE 8" PINE
33' LT. STA. 518+33 EL. 531.33

EXC. - 272 C.Y.
BOR. EXC. - 3273 C.Y.
SUB. TOT. - 3545 C.Y.
LESS BOR. - 3273 C.Y.
TOT. EXC. - 272 C.Y.

EMB. - 272 C.Y.
30% - 818 C.Y.
SUB. TOT. - 3545 C.Y.
LESS BOR. - 3273 C.Y.
TOT. EMB. - 272 C.Y.

